

PART 5055
BODY POST
16 GA.
A = 1 1/4", 1 1/2", OR 1 3/4"

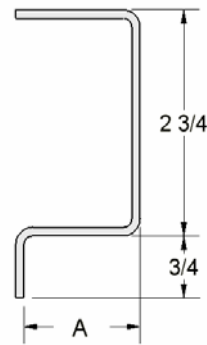

PART 5048
DOOR HEADER
12 GA.
A = 1 1/4", 1 1/2", OR 1 3/4"

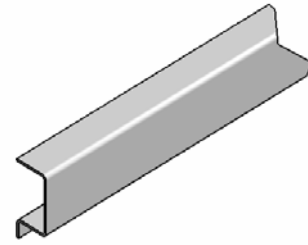
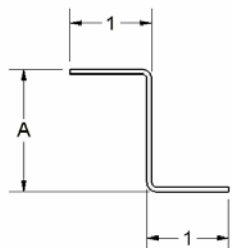
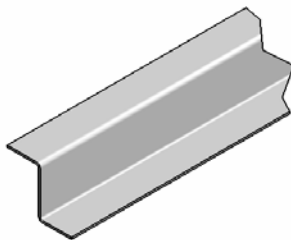

PART 5070
ZEE POST
16 GA.
A = 1 1/4", 1 1/2", OR 1 3/4"

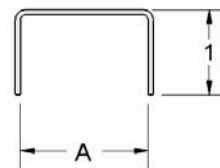
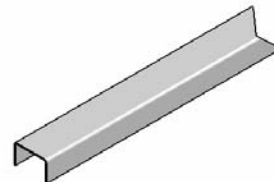

PART 5069
LINTEL—16 GA.
A = 1 1/4", 1 1/2", OR 1 3/4"

OTHER SIZES & MATERIALS ARE AVAILABLE ON REQUEST

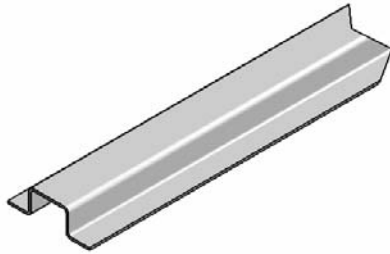

**PART 5572
HAT POST
16 GA.**

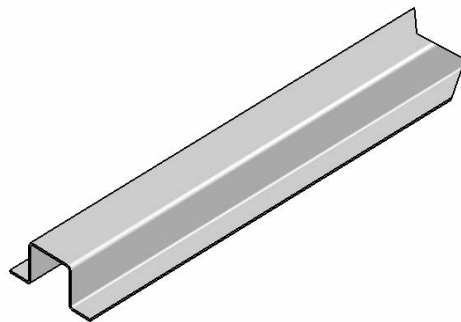
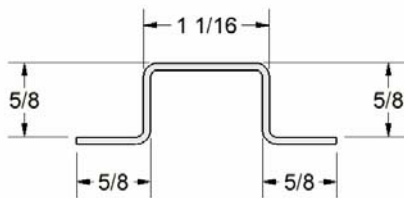

**PART 5573
HAT POST
16 GA.**

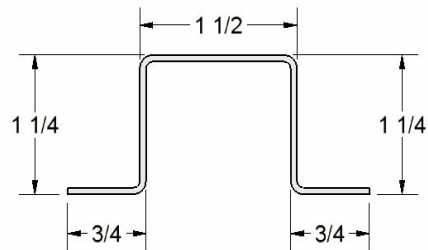

OTHER SIZES & MATERIALS ARE AVAILABLE ON REQUEST

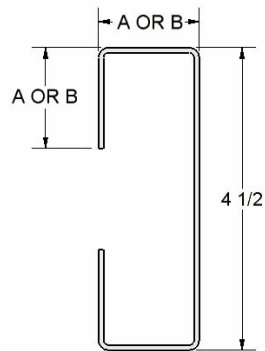
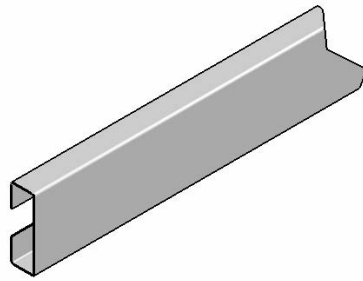

PART 5121
DOOR POST
14 GA.
A = 1 1/4" B = 1 1/2"

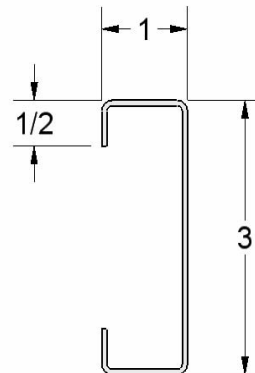
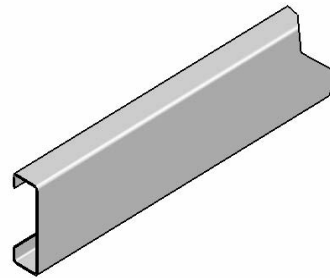

PART 5342
ROOF RAIL
16 GA.

OTHER SIZES & MATERIALS ARE AVAILABLE ON REQUEST

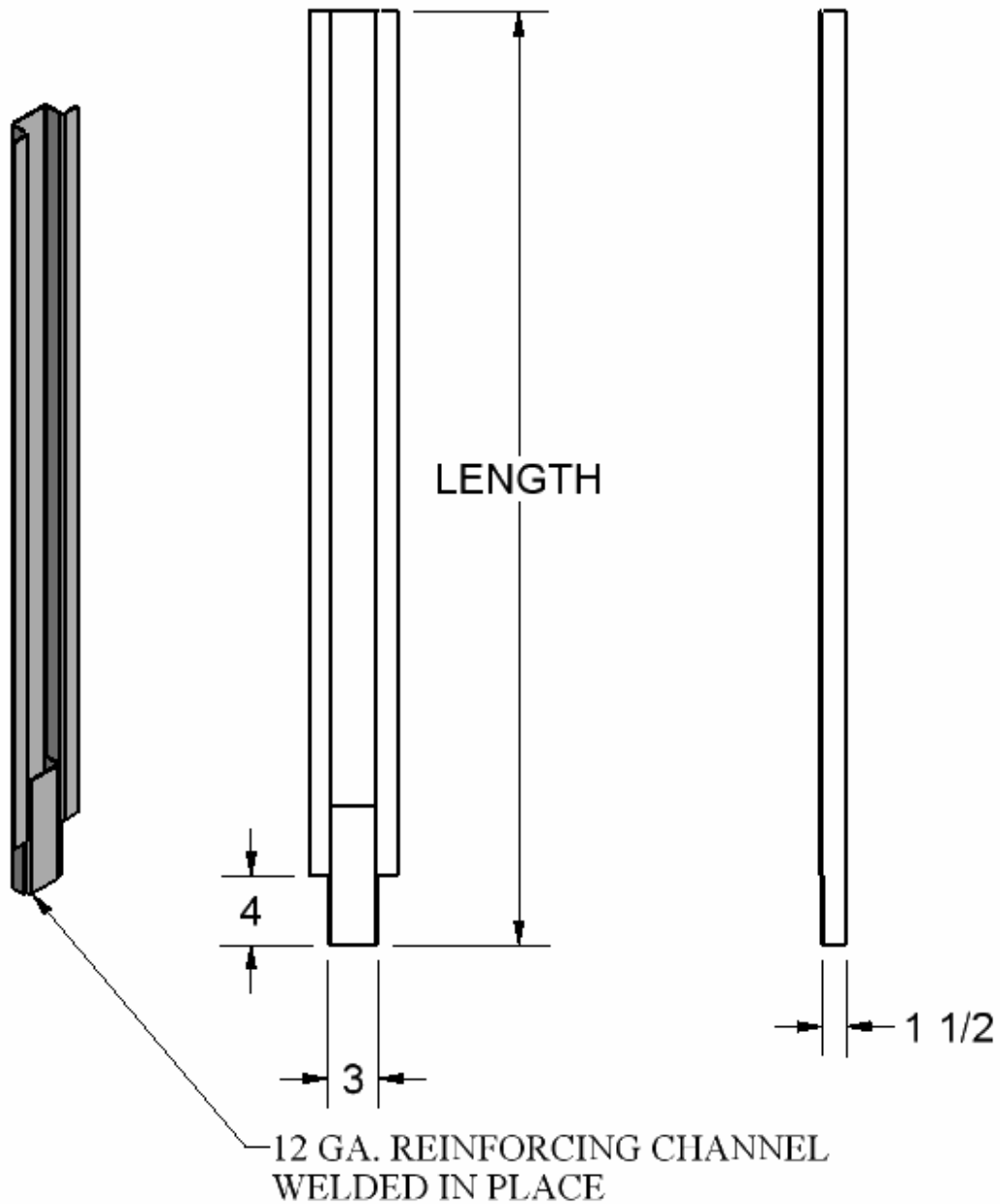

PART 5085
HEAVY DUTY STAKE
14GA. OR 12 GA.
FITS POCKETS 5086 &
5087

PART NO.	LENGTH
5085-46	46"
5085-52	52"

OTHER SIZES & MATERIALS ARE AVAILABLE ON REQUEST



**PART 5087
STAKE POCKET
12 GA.**

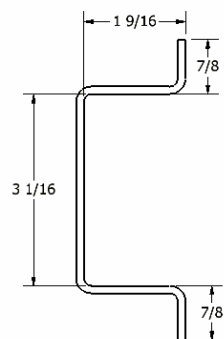
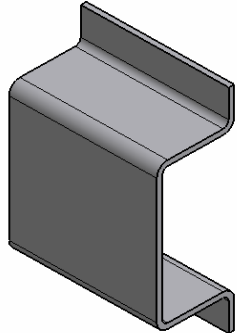
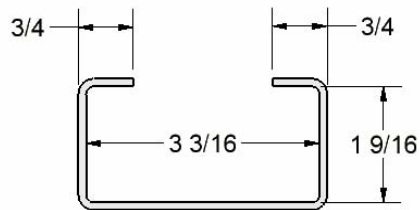

**PART 5086
STAKE POCKET
11 GA.**

OTHER SIZES & MATERIALS ARE AVAILABLE ON REQUEST

STAKE RACK CONNECTIONS

B2585B STRAIGHT SIDE RACK CONNECTIONS

7" OVERALL LENGTH $1\frac{1}{32}$ " HOLES FORMED FROM $2\frac{1}{2}$ " x $\frac{3}{16}$ " STOCK

5731 LEFT HAND PAIR

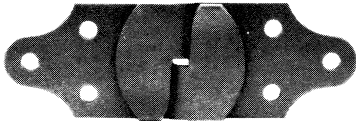

5731 RIGHT HAND PAIR

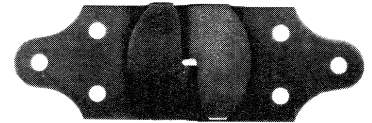

B2591B CORNER GATE CONNECTIONS

$\frac{3}{8}$ " OVERALL LENGTH TO INSIDE OF ANGLE WITH $1\frac{1}{32}$ " HOLES FORMED FROM $2\frac{1}{2}$ " x $\frac{3}{16}$ " STOCK

5732 LEFT HAND PAIR

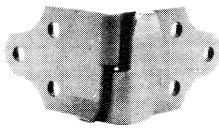

5732 RIGHT HAND PAIR

